

# Group 3

## Evaluation of seismic resistance of buildings in Peru

### Group Leaders

Dr. Carlos Zavala

PI - SATREPS Peruvian side

Dr. Taiki Saito

Professor, Toyohashi University of Technology

## EXISTING BUILDING TYPES IN PERU



**Adobe**



**Quincha**



**Concrete  
Ductility Walls**



# 1. How strong the building against earthquakes?

## Test of Material Strength



CISMID

## Test of Structural Walls





## 2. How to evaluate real building behavior?

### Monitoring using IT sensors



## Installation of IT sensors



Sensor at ceiling



Sensor at ground

Obtained record for **earthquake on 31 Dec. 2012**

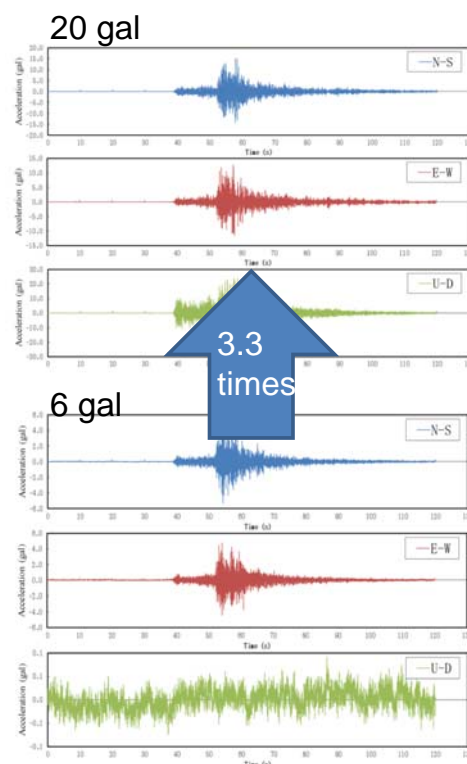

*Roof level*

*Basement level*

# Computer simulation

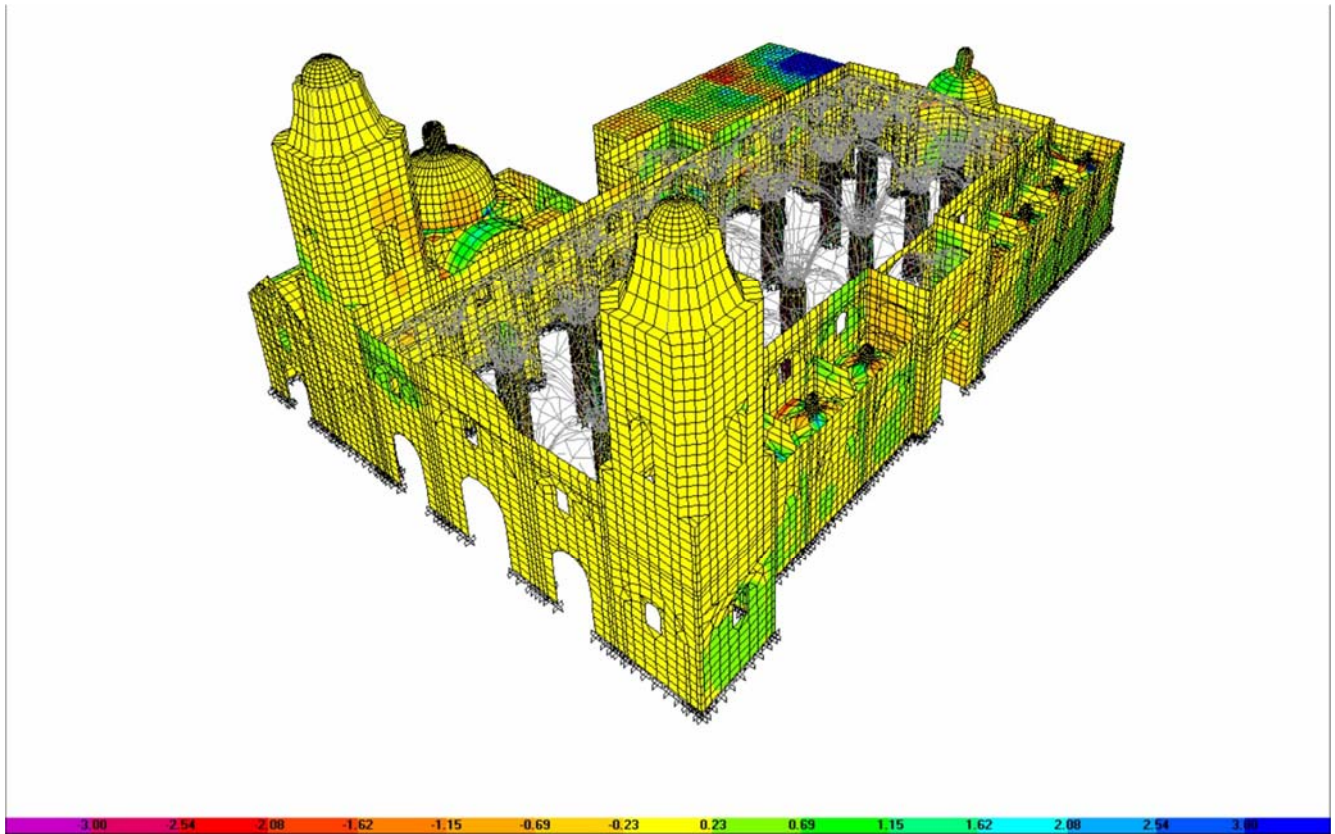

**SANTO DOMINGO**



**SAN FRANCISCO**



**SAN AGUSTIN**



**CATHEDRAL OF LIMA**



Check List for simple evaluation

**SAN PEDRO**



**LA MERCED**



**MAIN  
CHURCHES OF  
LIMA CENTER**